

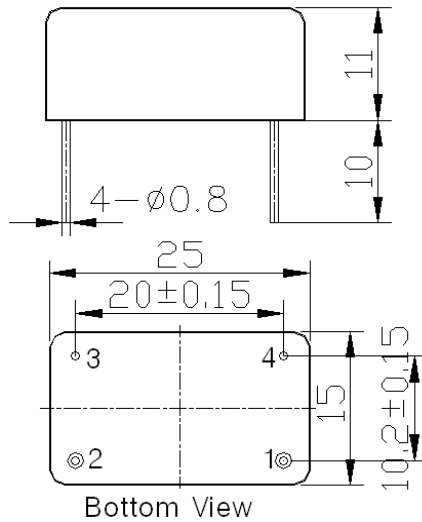

Specification: 100MHz Crystal Filter

Part Number:100M03B53

Item	Typical
Nominal Frequency (MHz)	100
Insertion Loss (dB)	10.0
Ripple within Pass Band (dB)	1.0
Bandwidth at -3dBc (kHz)	3.0
Bandwidth at 40 dBc Attenuation (kHz)	11.0
Ultimate Rejection (dB)	50
Spurious Response (dB)	-30
Input/Output Impedance (Ω)	50
Input Power Max (dBm)	0
Operation Temperature ($^{\circ}\text{C}$)	-20 ~ +70
Storage Temperature ($^{\circ}\text{C}$)	-50 ~ +85
Size (mm)	25 x 15x 11



Pin No.	Description
1	Input/Output
2	Output/Input
3,4	Ground

Unit:mm